

**REDUCE  
THE  
SPEED**



**Speedo Tech**  
**engineering**



[www.speedotechengg.com](http://www.speedotechengg.com)

# NMRV SERIES WORM GEAR BOX

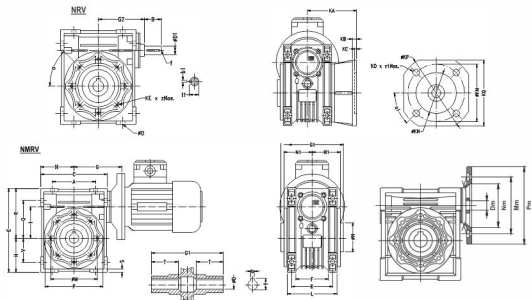

### Dimension of NMRV

MODEL	A	C	G	E	H	I	K	KE	L	M	N(h)	O	Q	R	S	V	OUTPUT				
																	G1	D(H7)	b	t	KA
BOX 30	54	80	55	97	40	30	44	M6X11(n 4)	56	65	55	6.5	44	57	5.5	27	63	14	5	16.3	54.5
BOX 40	70	101	72	121	50	40	60	M6X10(n 4)	71	75	60	6.5	55	71.5	6.5	35	78	18	6	20.8	67/97
BOX 50	80	121.5	89.5	144	60	50	70	M8x10(n 4)	85	85	70	8.5	64	84	7	40	92	25	8	28.3	90/120
BOX 63	100	147.5	104.5	174	72	63	85	M8X14(n 8)	103	95	80	8.5	80	102	8	50	112	25	8	28.3	82/112
BOX 75	120	174	114	205	86	75	90	M8x14(n 8)	112	115	95	11.5	93	119	10	60	120	28	8	31.3	111
BOX 90	140	208	129.5	238	103	90	100	M10x18(n 8)	130	130	110	13	102	135	11	70	140	35	10	38.3	111
BOX 110	170	255	153.5	295	128.5	110	115	M10x18(n 8)	144	165	130	14	125	167.5	14.5	85	155	42	12	45.3	131
BOX 130	200	292.5	180	335	147.5	130	120	M12x21(n 8)	155	215	180	16	140	187.5	15.5	100	170	45	14	48.8	140
BOX 150	240	340	210	400	170	150	145	M12x21(n 8)	185	215	180	18	180	230	18	120	200	50	14	53.8	155

### Input and Combination

MODEL	MOTOR TYPE	Nm	Mm	Pm	Dm	tm	bm
BOX 30	63 B5	95	115	140	11	12.8	4
	B14	60	75	90			
BOX 40	63 B5	95	115	140	11	12.8	4
	63 B14	60	75	90	11	12.8	4
	71 B5	110	130	160	14	16.3	5
	71 B14	70	85	105	14	16.3	5
BOX 50	63 B5	95	115	140	11	12.8	4
	71 B5	110	130	160	14	16.3	5
	71 B14	70	85	105	14	16.3	5
	80 B5	130	165	200	19	21.8	6
BOX 63	80 B14	80	100	120	19	21.8	6
	71 B5	110	130	160	14	16.3	5
	71 B14	70	85	105	14	16.3	5
	80 B5	130	165	200	19	21.8	6
	80 B14	80	100	120	19	21.8	6
	90 B5	130	165	200	24	27.3	8

BOXTYPE	MOTOR TYPE	Nm	Mm	Pm	Dm	tm	bm	
BOX 30	80 B5	19	21.8	6				
	90 B5	130	165	200	24	27.3	8	
	100 B5	180	215	250	28	31.3	8	
BOX 75	100 B14	110	130	160	28	31.3	8	
	112 B5	180	215	250	28	31.3	8	
	80 B5	130	165	200	19	21.8	6	
BOX 90	90 B5	130	165	200	24	27.3	8	
	100 B14	110	130	160	28	31.3	8	
	100 B5	180	215	250	28	31.3	8	
BOX 110	112 B5	180	215	250	28	31.3	8	
	132 B5	230	265	300	38	41.3	10	
	90 B5	130	165	200	24	27.3	8	
BOX 130	110/112	85	180	215	250	28	31.3	8
	132 B5	230	265	300	38	41.3	10	
	110/112	85	180	215	250	28	31.3	8
BOX 150	132 B5	230	265	300	38	41.3	10	
	160 B5	250	300	350	42	45	12	

# NMRV SERIES WORM GEAR BOX



## SELECTION TABLE

Model	Ratio(i)	Motor (Kw)	RPM (n2)
<b>BOX 30</b>	7.5	0.18	187
	10		140
	15		93
	20		70
	25		56
	30		46.9
	40		35
	50		28

Model	Ratio(i)	Motor (Kw)	RPM (n2)
<b>BOX 40</b>	7.5	0.37	187
	10		140
	15		93
	20		70
	25	56	
	30	46.9	
	40	0.25	35
	50	28	
	60	23	
		0.18	

Model	Ratio(i)	Motor (Kw)	RPM (n2)
<b>BOX 50</b>	7.5	0.75	187
	10		140
	15		93
	20	70	
	25	0.55	56
	30	46.9	
	40	35	
	50	0.37	28
	60	23	
	80	17.5	
100	0.18	14	

Model	Ratio(i)	Motor (Kw)	RPM (n2)
<b>BOX 63</b>	7.5	1.5	187
	10		140
	15		93
	20	1.1	70
	25	56	
	30	0.75	46.9
	40	35	
	50	0.55	28
	60	23	
	80	0.37	17.5
100	14		

Model	Ratio(i)	Motor (Kw)	RPM (n2)
<b>BOX 75</b>	7.5	2.2	187
	10		140
	15		93
	20	70	
	25	1.5	56
	30	46.9	
	40	35	
	50	1.1	28
	60	23	
	80	0.75	17.5
100	14		

Model	Ratio(i)	Motor (Kw)	RPM (n2)
<b>BOX 90</b>	7.5	4	187
	10		140
	15		93
	20	70	
	25	56	
	30	2.2	46.9
	40	35	
	50	28	
	60	1.5	23
	80	1.1	17.5
100	14		

Model	Ratio(i)	Motor (Kw)	RPM (n2)
<b>BOX 110</b>	7.5	4	187
	10		140
	15		93
	20		70
	25	56	
	30	46.9	
	40	35	
	50	2.2	28
	60	23	
	80	17.5	
100	1.5/1.1	14	

Model	Ratio(i)	Motor (Kw)	RPM (n2)
<b>BOX 130</b>	7.5	7.5	187
	10		140
	15		93
	20		70
	25	56	
	30	46.9	
	40	35	
	50	4	28
	60	23	
	80	17.5	
100	2.2	14	

Model	Ratio(i)	Motor (Kw)	RPM (n2)
<b>BOX 150</b>	15	7.5	93
	20		70
	25		56
	30	5.5	46.9
	40	35	
	50	28	
	60	4	23
	80	17.5	
	100	2.2	14

# SP SERIES (TWO STAGE) HELICAL GEAR BOX

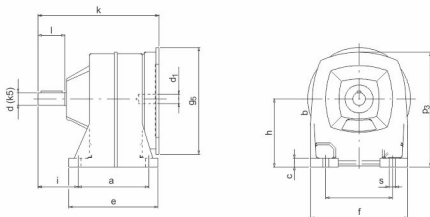

MODEL	Weight (kg)	d1	g5	k	a	b	c	e	f	h	i	p3	s	d	l
SP 102	11	14	160	181	106	100	13	134	150	102	60	176	9	19	40
	10	19	200	225											
SP 128	17	14	160	207	126	118	16	160	178	128	74	215	11	24	50
	17	19	200	225											
	17	24	200	242											
SP 142	24	19	200	253	145	130	18	179	196	142	95	237	11	28	60
	24	24	200	270											
	24	28	250	312											
SP 162	39	19	200	338	205	160	21	245	226	162	120	269	14	38	80
	39	24	200	338											
	39	28	250	341											
SP 160	50	28	250	409	270	195	24	310	276	160	137	319	13	48	110
	50	28	250	409											
	54	38	300	435											

Model : SP 102			Model : SP 128			Model : SP 142			Model : SP 162			Model : SP 160		
Ratio	HP	RPM	Ratio	HP	RPM	Ratio	HP	RPM	Ratio	HP	RPM	Ratio	HP	RPM
44.6	0.5	32	33.4	1.0	42	36.3	1.0/2.0	39	32.3	2.0/3	45	37	5.0	38
34.8		41	27.5		52	28.2		51	25.4		57	27		53
28.4		50	23.09		62	22.6	1.5/2.0	63	22.7	63	19.2	75	18.9	76
22.4		64	20.64		70	18.6		77	18.9	76	18.9	76		
17.1		84	18.65		77	15	96	13.4	3.0	107	14.8	97	14.8	97
14.2		101	16.8		85	11.4	126	11.4	126	10.7	135	10.7	135	
12		120	13.8		104	9.1	158	10.5	137	8.2	176	8.2	176	
9.4		152	11.5		125	7.2	15/2.0	199	9.4	153	6.3	229	6.3	229
7.23	0.5 / 1.0	199	9.68	149	5.8	/3.0	249	5.8	3.0 / 5.0	248	4.6	/5.5	313	
6.05		238	7.05	1.0 / 2.0	204		4.7	304		4.7	306		4.7	306
4.6		312	5.94	242	4.8	300	4.7	304	4.7	306	4.7	306		

# M-SERIES (THREE STAGE) HELICAL GEAR BOX

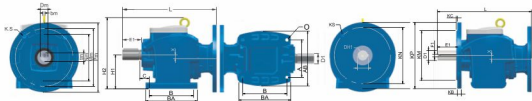

MODEL M:12	MOTOR TYPE	NM	MM	PM	DM	TM	BM	L	B	BA	A	AB	O	H1	H2	C	D1	E1	F1	DH1	KP	KM	KN	KS	KC	KB
	P71 B-5	110	130	160	14	16.5	5	244	105	127	90	135	9	85	155	20	25	50	8	8	140	95	115	9	3	10
	P80 B-5	130	165	200	19	22	6	244	105	127	90	135	9	85	155	20	25	50	8	8	140	95	115	9	3	10
	P71 B-14	70	85	105	14	16.5	5	244	105	127	90	135	9	85	155	20	25	50	8	8	140	95	115	9	3	10

MODEL M:21	MOTOR TYPE	NM	MM	PM	DM	TM	BM	L	B	BA	A	AB	O	H1	H2	C	D1	E1	F1	DH1	KP	KM	KN	KS	KC	KB
	P71 B-5	110	130	160	14	16.5	5	276	130	155	110	165	11	100	194	25	30	60	8	10	200	130	165	11	4	12
	P80 B-5	130	165	200	19	22	6	276	130	155	110	165	11	100	194	25	30	60	8	10	200	130	165	11	4	12
	P80 B-5	130	165	200	24	28	8	276	130	155	110	165	11	100	194	25	30	60	8	10	200	130	165	11	4	12

MODEL M:30	MOTOR TYPE	NM	MM	PM	DM	TM	BM	L	B	BA	A	AB	O	H1	H2	C	D1	E1	F1	DH1	KP	KM	KN	KS	KC	KB
	P80 B-5	130	165	200	19	22	6	340	165	200	135	210	14	115	240	30	35	70	10	12	200	130	165	11	4	12
	P90 B-5	130	165	200	24	28	8	340	165	200	135	210	14	115	240	30	35	70	10	12	200	130	165	11	4	12
	P100 B-5	180	215	250	28	32	8	340	165	200	135	210	14	115	240	30	35	70	10	12	250	180	215	14	4	15
	P112 B-5	180	215	250	28	32	8	340	165	200	135	210	14	115	240	30	35	70	10	12	250	180	215	14	4	15

MODEL M:50	MOTOR TYPE	NM	MM	PM	DM	TM	BM	L	B	BA	A	AB	O	H1	H2	C	D1	E1	F1	DH1	KP	KM	KN	KS	KC	KB
	P80 B-5	130	165	200	19	22	6	380	195	225	150	240	14	135	265	30	40	80	12	16	200	130	165	11	4	12
	P90 B-5	130	165	200	24	28	8	380	195	225	150	240	14	135	265	30	40	80	12	16	200	130	165	11	4	12
	P100 B-5	180	215	250	28	32	8	380	195	225	150	240	14	135	265	30	40	80	12	16	250	180	215	14	4	15
	P112 B-5	180	215	250	28	32	8	380	195	225	150	240	14	135	265	30	40	80	12	16	250	180	215	14	4	15

MODEL M:75	MOTOR TYPE	NM	MM	PM	DM	TM	BM	L	B	BA	A	AB	O	H1	H2	C	D1	E1	F1	DH1	KP	KM	KN	KS	KC	KB
	P90 B-5	130	165	200	24	28	8	400	205	235	170	250	17	140	290	35	50	100	14	16	250	180	215	14	4	19
	P100 B-5	180	215	250	28	32	8	400	205	235	170	250	17	140	290	35	50	100	14	16	250	180	215	14	4	19
	P112 B-5	180	215	250	28	32	8	400	205	235	170	250	17	140	290	35	50	100	14	16	250	180	215	14	4	19
	P132 B-5	230	265	300	38	42.5	12	410	205	235	170	250	17	140	290	35	50	100	14	16	300	230	265	14	4	19

MODEL M:150	MOTOR TYPE	NM	MM	PM	DM	TM	BM	L	B	BA	A	AB	O	H1	H2	C	D1	E1	F1	DH1	KP	KM	KN	KS	KC	KB
	P100 B-5	180	215	250	28	32	8	450	260	306	215	307	18	180	360	40	60	120	18	20	300	230	265	14	4	19
	P112 B-5	180	215	250	28	32	8	450	260	306	215	307	18	180	360	40	60	120	18	20	300	230	265	14	4	19
	P132 B-5	230	265	300	38	42.5	12	450	260	306	215	307	18	180	360	40	60	120	18	20	300	230	265	14	4	19

## IN-PUT 1440 RPM

RATIO	80:1	72:1	60:1	51.4:1	45:1	40:1	36:1	30:1	25:1	20:1	17:1	15:1	10:1	7.5:1	6:1	4.8:1
R.P.M.	18	20	24	28	32	36	40	48	58	72	85	96	144	192	240	300
0.5 HP / 0.37 KW	21	21	21	12	12	12	12	12	12	12	12	12	12	12	12	12
0.75 HP / 0.55 KW	30	30	21	21	21	21	21	21	12	12	12	12	12	12	12	12
1 HP / 0.75 KW	30	30	30	21	21	21	21	21	21	21	12	12	12	12	12	12
1.5 HP / 1.1 KW	60	60	60	60	60	30	30	30	21	21	21	21	21	21	21	21
2 HP / 1.5 KW	85	85	60	60	60	60	60	30	30	30	30	21	21	21	21	21
3 HP / 2.2 KW	85	85	85	60	60	60	60	30	30	30	30	30	30	30	30	30
5 HP / 3.7 KW	150	150	150	150	85	85	85	85	85	85	60	60	60	30	30	30
7.5 HP / 5.5 KW	300	300	300	300	150	150	150	150	150	150	85	85	85	85	85	85
10 HP / 7.5 KW	-	-	-	300	300	300	300	150	150	150	150	85	85	85	85	85

# PROFILE

Established in the year 2013, we, "Speedo Tech Engineering", have emerged as a distinguished Manufacturer & Supplier of Helical Gear boxes, NMRV Gearbox and Gear motors. These are acclaimed for low maintenance, corrosion-resistance, optimum performance and longer service life. Due to these features, our products are widely accepted in the industry. Further, we procure these products Raw Materials from reliable manufacturers, who ensure to use quality raw material in the production process. With the help of our vendor-base, we can offer our products as per the specifications given by clients.

We have built a modern infrastructure, which comprises quality testing unit and warehousing & packaging department. With the help of quality testing unit, we check the products on varied well-defined parameters, including design and efficiency. Further, our warehousing unit helps us store the quality approved products under appropriate conditions. We deliver our products through efficient distribution network, at the location mentioned by the clients.



**Speedo Tech**  
engineering

Our Dealer



Manufacturer of : All Types of Gearbox & Gear Motors

B/10/1 Anup Estate, B/h. Bharat Party Plot,  
Rabari Colony Cross Road, Ahmedabad-380026, Gujarat, India.  
M : +91 97129 70484, +91 90167 10550

Email : [speedotechengg@gmail.com](mailto:speedotechengg@gmail.com)  
[speedotechengineering@gmail.com](mailto:speedotechengineering@gmail.com)  
Website : [www.speedotechengg.com](http://www.speedotechengg.com)